

THE COPYRIGHT OF THIS DRAWING IS VESTED WITH CW O'BRIEN ARCHITECTS LIMITED AND MUST NOT BE COPIED OR REPRODUCED WITHOUT THE CONSENT OF THE COMPANY.

FIGURED DIMENSIONS ONLY TO BE TAKEN FROM THIS DRAWING. DO NOT SCALE.

ALL CONTRACTORS MUST VISIT THE SITE AND BE RESPONSIBLE FOR CHECKING ALL SETTING OUT DIMENSIONS AND NOTIFYING THE ARCHITECT OF ANY DISCREPANCIES PRIOR TO ANY MANUFACTURE OR CONSTRUCTION WORK.

NOTES:

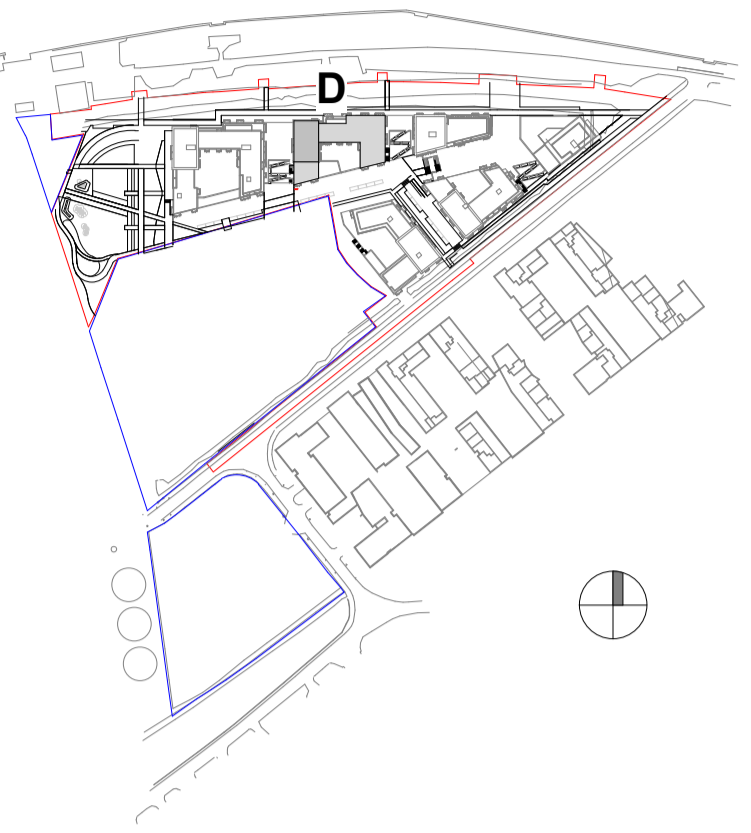

SITE OUTLINE RED
LANDS IN APPLICANT'S OWNERSHIP

FLOOR PLAN KEY:
EH - ENTRANCE HALL
ST - STORAGE
HP - HOT PRESS
KIT/LIV/DIN - KITCHEN + LIVING + DINING ROOM

AREA TYPES

- 1 BED
- 2 BED
- 3 BED
- CIRCULATION

FLOOR PLAN KEY:
- - - - - PROPOSED PART V UNITS, INCLUDING PRIVATE AMENITY SPACE
PROPOSED PART V APARTMENTS NOTED IN RED



Rev	Date	Description	Issued By
P01	28/03/2022	ISSUED FOR PLANNING	EB

Project Stage
PLANNING

Client:
Tiznow Property Company Limited
(Comer Group Ireland)

Project:
City Park Development
at the Former Tedcastles Site,
Centre Park Road, Cork

Drawing Title:
PLAN - BLOCK D - LEVEL 02 - 03 - PART V

Drawn	Checked	Paper Size	Scale	Date
VF	EB	A1	1:200 @A1	03/18/22

Project No.	Drawing No.	Classification	Revision
PE21055	2413		P01

File Name:
PE21055-CWO-04-02-DR-A-2413

Status:
A1 - Authorized and accepted for planning stage



No.1 Sarsfield Quay, Dublin 7, D07 R9FH
t: 01 518 0170 e: admin@cwoarchitects.ie
Dublin | Cork | Galway | London | UK & Europe +
www.cwoarchitects.ie

Please consider the environment before printing this sheet